

03 0307

Circular connectors with threaded joint M16 acc. to IEC 61076-2-106, IP40/IP68



Chassis socket acc. to IEC 61076-2-106, IP68, with threaded joint, for printed circuit boards, for back side mounting

03 0307

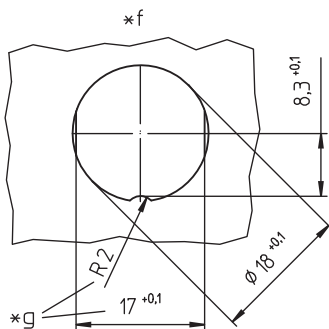
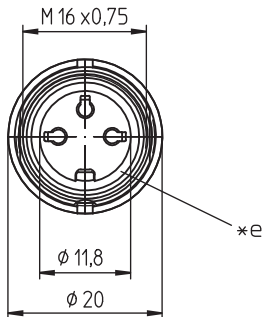
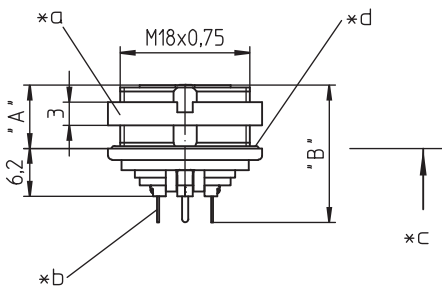
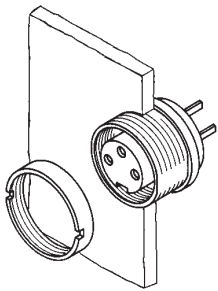

Environmental conditions

Temperature range -40 °C/+85 °C

Materials

| | |
|-----------------|---|
| Insulating body | PA GF, V-0 according to UL94 |
| Contact bush | CuZn, silver-plated and flash gold-plated, tin-plated in solder area (3-8 poles) CuZn, pre-nickel and gold-plated, tin-plated in solder area (12-14 poles) |
| Housing | Zn diecast, pre-copper and nickel-plated |
| Ring screw | CuZn, nickel-plated |
| Seal | CR (flat), NBR (O-ring) |

Mechanical data

| | |
|-----------------------------|---|
| Insertion force/contact | $\leq 5,0 \text{ N}^1$ |
| Withdrawal force/contact | $\geq 1,2 \text{ N}$ (3-8 poles) $\geq 0,9 \text{ N}$ (12-14 poles) ¹ |
| Tightening torque connector | 1-3 Nm |
| Tightening torque nut | 1-3 Nm |
| Protection class | IP68 ² |

¹ measured with a polished steel pin, nominal thickness 1.5 mm (1.0 mm with 12-14 poles)

² according to IEC DIN EN 60529, only in locked condition with an appropriate counterpart; IPX8 requirements under agreement between manufacturer and user

Electrical data (at $T_{\text{amb}} 20 \text{ °C}$)

| | |
|-----------------------|---|
| Contact resistance | $\leq 5 \text{ m}\Omega$ |
| Rated current | 5 A ($T_{\text{amb}} 40 \text{ °C}$, 3-8 poles) 3 A ($T_{\text{amb}} 40 \text{ °C}$, 12-14 poles) |
| Rated voltage | with pollution degree 1: 300 V (versions 03, 04, 05-1, 06, 07) 100 V (versions 05, 07-1, 08, 08-1) 160 V (versions 12, 14) with pollution degree 2: 250 V (versions 03, 04) 32 V (versions 05, 07-1, 08, 08-1) 160 V (versions 05-1, 06, 07, 12, 14) |
| Rated impulse voltage | 1500 V (versions 03, 04, 05-1, 06, 07, 12, 14) 500 V (versions 05, 07-1, 08, 08-1) |
| Material group | II (IEC)/1 (UL) (400 \leq CTI < 600) |
| Overvoltage category | I |
| Insulation resistance | > 100 M Ω |

03

0307

Pin configurations, solder side view

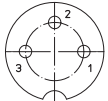

03-a
0307 03

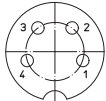

04-a
0307 04

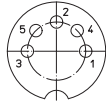

05-b
0307 05

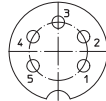

05-a
0307 05-1

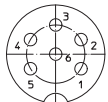

06-a
0307 06



07-a
0307 07

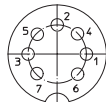

07-b
0307 07-1



0307 08



08-a
0307 08-1





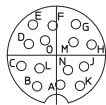



12-a
0307 12









14-a
0307 14

Associated products

Counterparts

| | | |
|--|--|--|
|  0331 |  0332 |  0332-1 |
|  033200 |  0365 |  036500 |

Accessories

| | | |
|---|--|--|
|  0322 C 16 |  0381 |  038199 |
|  0384 |  0385 |  038799 |

Harnessing equipment

 ZMS 20

03 0307

Printed circuit board layout, solder side view

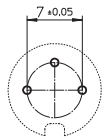

03-a
0307 03

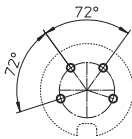

04-a
0307 04

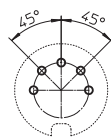

05-b
0307 05

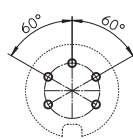

05-a
0307 05-1

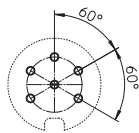

06-a
0307 06

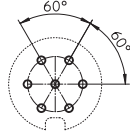

07-a
0307 07

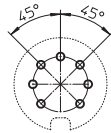

07-b
0307 07-1

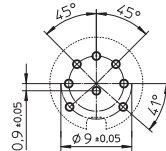

0307 08

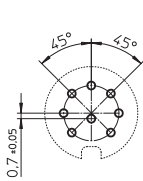

08-a
0307 08-1

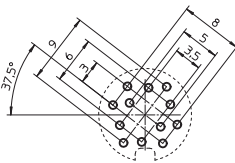

12-a
0307 12

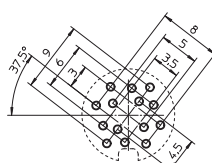

14-a
0307 14

- *a nut enclosed separately
- *b for bore hole of PCB
Ø 1,0 mm (0307 03-0307 08-1)
Ø 0,7 mm (0307 12-0307 14)
- *c mounting direction
- *d O-ring gasket
- *e flat gasket
- *f port in mounting plate
- *g anti-rotation, alternative execution

03

0307

| Designation | Pole Number | PU (Pieces) | MDQ (Pieces) | Dimensions | |
|-------------|-------------|-------------|--------------|------------|--------|
| | | | | A (mm) | B (mm) |
| 0307 03 | 3 | 50 | 100 | 8.2 | 17.8 |
| 0307 04 | 4 | 50 | 100 | 8.2 | 17.8 |
| 0307 05 | 5 | 50 | 100 | 8.2 | 17.8 |
| 0307 05-1 | 5 | 50 | 100 | 8.2 | 17.8 |
| 0307 06 | 6 | 50 | 100 | 8.2 | 17.8 |
| 0307 07 | 7 | 50 | 100 | 8.2 | 17.8 |
| 0307 07-1 | 7 | 50 | 100 | 8.2 | 17.8 |
| 0307 08 | 8 | 50 | 100 | 8.2 | 17.8 |
| 0307 08-1 | 8 | 50 | 100 | 8.2 | 17.8 |
| 0307 12 | 12 | 50 | 100 | 7.9 | 17.1 |
| 0307 14 | 14 | 50 | 100 | 7.9 | 17.1 |

Packaging:

in a cardboard box