

15

1501 12

## Jack connectors



Jack chassis socket acc. to JIS C 6560 JC25J3B, 2.5 mm, 3 poles/stereo, angular version, with 2 break contacts, for printed circuit boards, surface mounting technology (SMT)

---

State: Obsolete

---

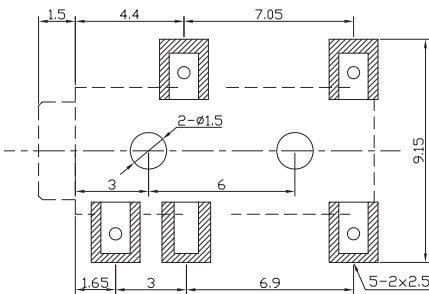
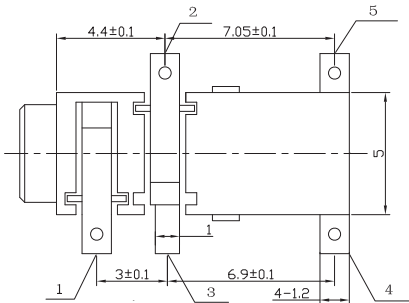
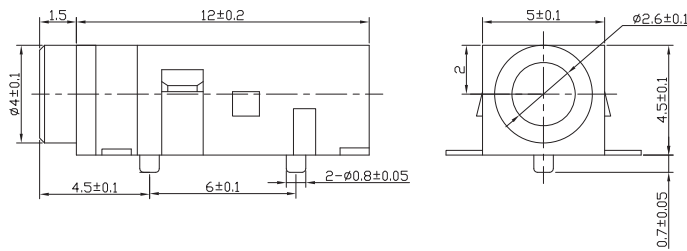

\*a

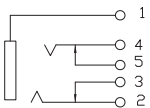

\*a printed circuit board layout, solder side view

**Environmental conditions**

Temperature range -20 °C/+70 °C

**Materials**

Insulating body PA GF, V-0 according to UL94  
Contact spring Cu alloy, silver-plated

**Mechanical data**

Mating cycles 5000  
Insertion force 3–30 N<sup>1</sup>  
Withdrawal force 3–30 N<sup>1</sup>

<sup>1</sup> measured with a gauge plug, initial value

**Electrical data (at T<sub>amb</sub> 20 °C)**

Contact resistance ≤ 50 mΩ  
Rated current 1 A  
Rated voltage 12 V DC  
Rated impulse voltage 250 V/60 s  
Insulation resistance ≥ 100 MΩ

**Associated products**

Counterparts  
☞ KLS 13

15

1501 12

Designation	Pole Number	PU (Pieces)	MDQ (Pieces)
1501 12 VP3	3	1000	1000

**Packaging:**

on reel