

15

1502 03

Jack connectors



Jack chassis socket acc. to JIS C 6560 JC35J2B, 3.5 mm, 2 poles/mono, straight/upright version, with break contact and solder eyes, for printed circuit boards, for back side mounting

15

1502 03

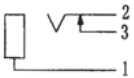
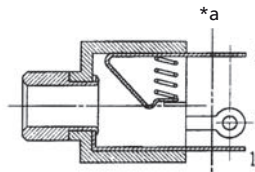
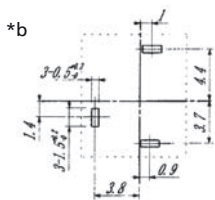
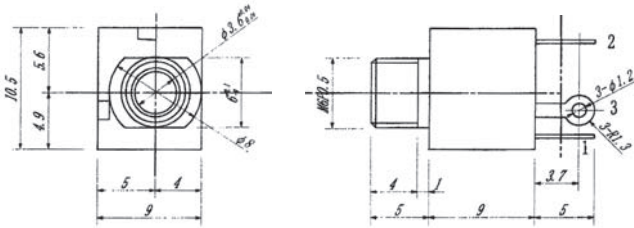

*a cutting line
*b printed circuit board layout, components side view

Environmental conditions

Temperature range -20 °C/+70 °C

Materials

Insulating body PC GF, V-2 according to UL94
Contact spring CuZn, nickel-plated/silver-plated

Mechanical data

Mating cycles ≥ 5000
Insertion force 5–20 N
Withdrawal force 4–20 N

Electrical data (at $T_{amb} 20\text{ °C}$)

Contact resistance $\leq 20\text{ m}\Omega$
Rated current 1 A
Rated voltage 34 V AC/DC
Rated impulse voltage 500 V/60 s
Insulation resistance $\geq 100\text{ M}\Omega$

Associated products

Counterparts
[☞ 1532 06](#) [☞ KLS 2](#) [☞ KLS 22](#)
[☞ WKLS 2](#)

15

1502 03

| Designation | Pole Number | PU (Pieces) | MDQ (Pieces) |
|-------------|-------------|-------------|--------------|
| 1502 03 | 2 | 500 | 500 |

Packaging:

in bulk, in a cardboard box or a plastic bag