

16

1613 23

Power supply connectors



Power supply chassis socket, angular version, with bayonet lock, with break contact, for printed circuit boards

16

1613 23

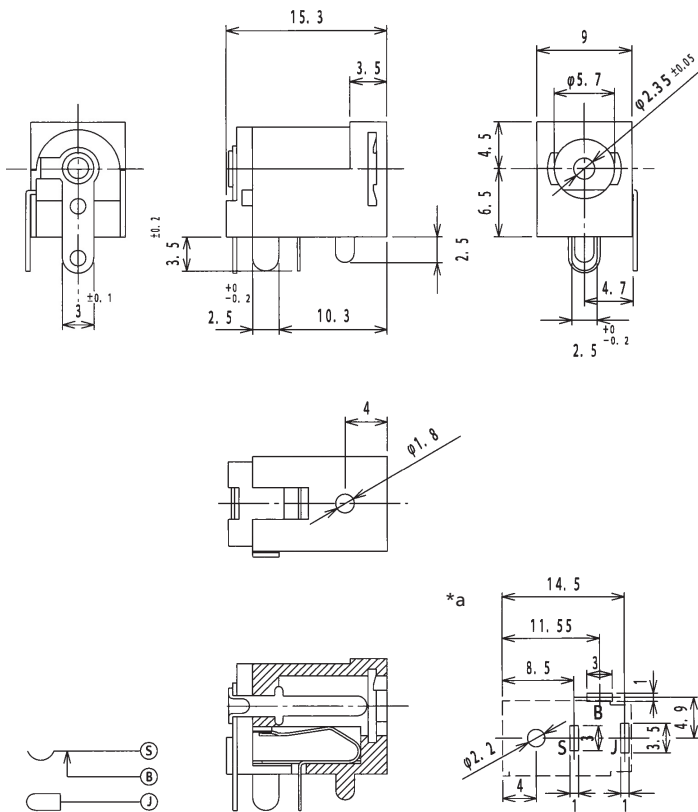

*a printed circuit board layout, solder side view

Environmental conditions

Temperature range -20 °C/+70 °C

Materials

Insulating body PC, V-2 according to UL94
Contact Cu alloy, nickel-plated/tin-plated

Mechanical data

Diameter opening 5.7 mm
Diameter center pin 2.35 mm
Mating cycles ≥ 5000
Insertion force 5–20 N
Withdrawal force 4–15 N

Electrical data (at $T_{amb} 20\text{ °C}$)

Contact resistance $\leq 30\text{ m}\Omega$
Rated current 1 A
Rated voltage 12 V DC
Rated impulse voltage 500 V/60 s
Insulation resistance $\geq 100\text{ M}\Omega$

Associated products

Counterparts
 1634 01

16

1613 23

Designation	Pole Number	PU (Pieces)	MDQ (Pieces)
1613 23	2	250	500

Packaging:

in bulk, in a cardboard box or a plastic bag