

16

1614 16

Power supply connectors



Power supply chassis socket,
for plugs 5.5 mm x 2.1 mm, straight version, with solder
eyes, for front side mounting

16

1614 16

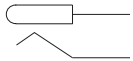
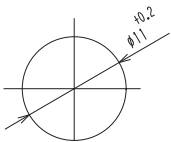
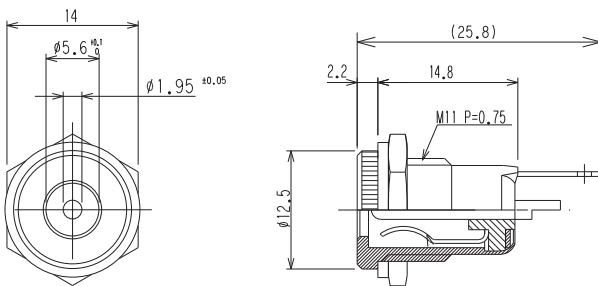

Environmental conditions

Temperature range -20 °C/+70 °C

Materials

Insulating body	POM
Contact	CuZn/CuSn/steel, nickel-plated/ silver-plated
Housing	CuZn, nickel-plated
Hexagonal nut	CuZn, nickel-plated
Spring washer	steel, nickel-plated





Mechanical data

Diameter opening	5.6 mm
Diameter center pin	1.95 mm
Mating cycles	≥ 5000
Insertion force	5–20 N
Withdrawal force	4–15 N

Electrical data (at T_{amb} 20 °C)

Contact resistance	≤ 30 m Ω
Rated current	0.5 A
Rated voltage	12 V DC
Rated impulse voltage	500 V/60 s
Insulation resistance	≥ 100 M Ω

Associated products

Counterparts			
 1633 03	 NES/J 21	 NES/J 21 W	
 NES/J 210	 XNES/J 210		

16

1614 16

Designation	Pole Number	PU (Pieces)	MDQ (Pieces)
1614 16	2	100	500

Packaging:

in bulk, in a cardboard box or a plastic bag