

35

83546

RAST 2.5 connectors, pitch 2.5/5.0 mm



RAST 2.5 double chassis pin header, with locking latches
contact pitch 5.0 mm

Approvals:



35 83546

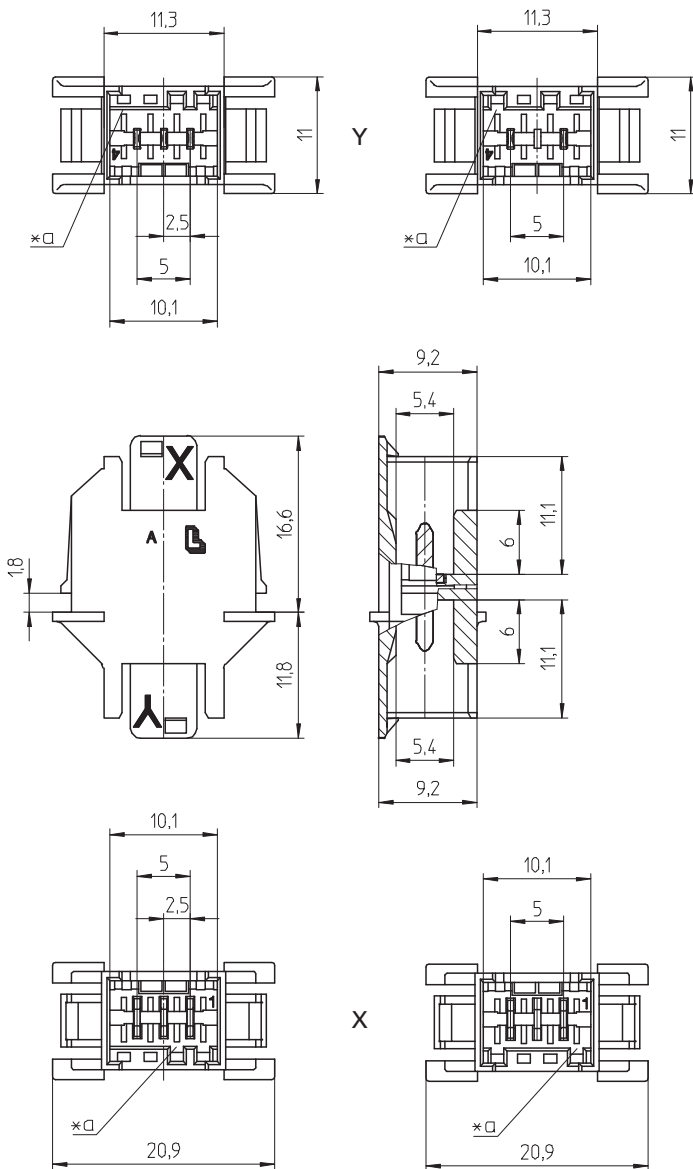

Environmental conditions

Temperature range -40 °C/+120 °C¹

¹ upper limit temperature (insulating body) RTI (electrical) of the UL Yellow Card

Materials

Insulating body PA GF, V-0 according to UL94¹

Contact pin CuZn, pre-nickel and tin-plated

¹ component glow wire resistant acc. to IEC 60695-2-11 and IEC 60335-1 respectively (GWT 750 °C without flame)

Mechanical data

Keying proposals at www.lumberg.com 

Electrical data (at T_{amb} 20 °C)

Rated current 4 A (T_u 60 °C)

2 A (T_u 100 °C)

Rated voltage 400 V AC (Verschmutzungsgrad 2)

250 V AC (Verschmutzungsgrad 3)

Material group IIIa (CTI ≥ 250)

Creepage distance 4,4 mm

Clearance 4,4 mm

Insulation resistance > 1 GΩ

Associated products

Counterparts

 3523

 3523-2

 352300

 3570

 357000

35

83546

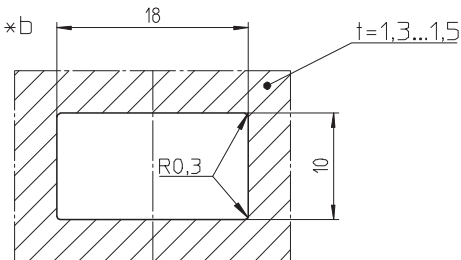

- *a keying
- *b port in mounting plate

35

83546

Designation	Pole Number	PU (Pieces)	MDQ (Pieces)
83546 02	2	500	4000

Designation to be completed by further details (e.g. for keying, color or material options).

Packaging:

in bulk, in a cardboard box