

61 KRM

Screw terminal blocks, pitch 3.5/5.0/10.0 mm



Screw terminal block, clamp with wire protector, upright version, consecutive placement without loss of pitch
contact pitch 5.0 mm

Approvals:  

61 KRM

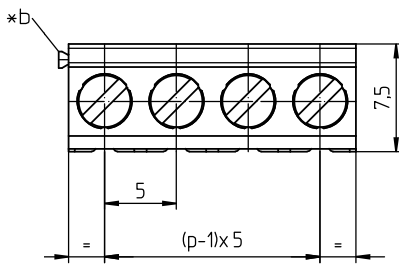
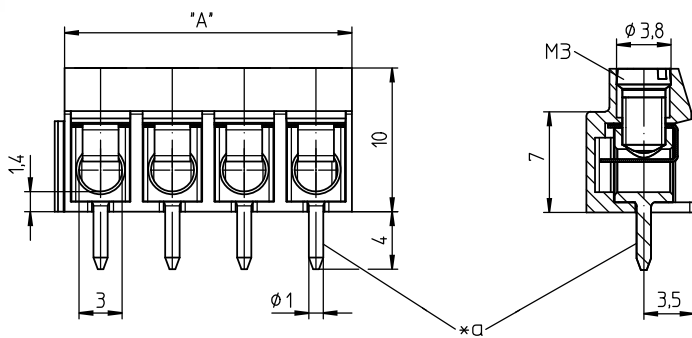

- *a solder pin for printed circuit board bore hole \varnothing 1.3 mm
- *b dovetail joint without loss of pitch

Environmental conditions

Temperature range -25 °C/+110 °C¹

¹ Continuous working temperature (according to IEC 60216) according to material manufacturer's data sheet

Materials

| | |
|-----------------|----------------------------------|
| Insulating body | PA, V-2 according to UL94 |
| Clamp | CuZn, pre-nickel and tin-plated |
| Wire protector | CuSn, nickel-plated |
| Screw | steel, zinc-plated and chromated |

Mechanical data

| | |
|-------------------------|--------|
| Screw size | M3 |
| Tightening torque screw | 0.5 Nm |

Connectable conductors for screw clamp

| | |
|------------------------------------|-------------------------|
| Section stranded wire | 0.2–2.5 mm ² |
| Section stranded wire with ferrule | 0.2–1.5 mm ² |
| Section solid wire | 0.2–2.5 mm ² |
| Stripping length | 7.0 ± 0.5 mm |

Electrical data (at T_{amb} 20 °C)

| | |
|-----------------------|---|
| Rated current | 15 A (VDE, T _{amb} 100 °C) |
| Rated voltage | 250 V AC (VDE)/300 V (B, CSA) ¹ |
| Material group | I (IEC)/0 (UL) (CTI ≥ 600) ² |
| Creepage distance | 1.3 mm, with maximum section connected (solid conductor 2.5 mm ²) |
| Clearance | 1.3 mm, with maximum section connected (solid conductor 2.5 mm ²) |
| Insulation resistance | > 10 GΩ |

¹ according to IEC 60664/DIN EN 60664

² according to ANSI/UL 746A

61 KRM

| Designation | Pole Number | PU (Pieces) | MDQ (Pieces) | Dimensions L (mm) |
|-------------|-------------|-------------|--------------|----------------------|
| KRM 02 | 2 | 200 | 1000 | 10 |
| KRM 03 | 3 | 200 | 1000 | 15 |
| KRM 04 | 4 | 200 | 1000 | 20 |
| KRM 05 | 5 | 200 | 1000 | 25 |
| KRM 06 | 6 | 200 | 1000 | 30 |
| KRM 07 | 7 | 200 | 1000 | 35 |
| KRM 08 | 8 | 200 | 1000 | 40 |
| KRM 09 | 9 | 200 | 1000 | 45 |
| KRM 11 | 11 | 200 | 1000 | 55 |
| KRM 12 | 12 | 200 | 1000 | 60 |

Packaging:

in bulk, in a cardboard box