

16

NES/J 135

Power supply connectors



Power supply plug,
3.4 mm x 1.4 mm, straight version, with solder eyes

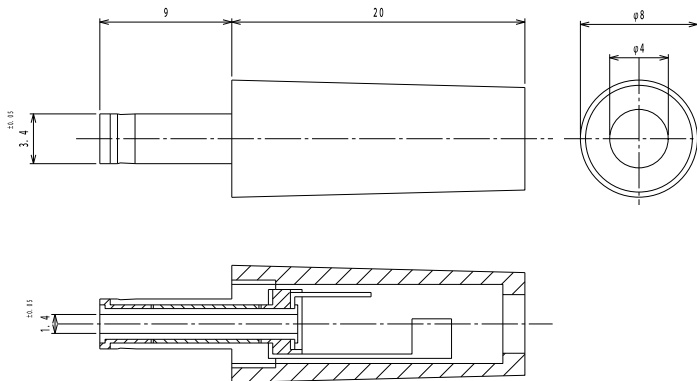

Environmental conditions

Temperature range -25 °C/+70 °C

Materials

Insulating body	PC
Contact	CuZn/CuSn, nickel-plated
Insulation	PVC/ebonite
Housing	ABS

Mechanical data

Outer diameter	3.4 mm
Inner diameter	1.4 mm

Connectable conductors for solder area

Cable diameter 4 mm

Electrical data (at T_{amb} 20 °C)

Rated current	0.5 A
Rated voltage	12 V DC
Rated impulse voltage	500 V/60 s
Insulation resistance	≥ 100 MΩ

Associated products

Counterparts
 ↗ 1613 12 ↗ 1613 20 ↗ 1614 17
 ↗ 1614 22

16

NES/J 135

Designation	Pole Number	PU (Pieces)	MDQ (Pieces)
NES/J 135	2	100	500

Packaging:

in bulk, in a cardboard box or a plastic bag